

**PIPE SUPPORT**

**RISER CLAMP**



1"	#RIC10
1-1/4"	#RIC12
1-1/2"	#RIC15
2"	#RIC20
3"	#RIC30
4"	#RIC40
5"	#RIC50
6"	#RIC60
8"	#RIC80

**U-BOLT WITH NUTS**



FITS I.P.S.

1/2"	#UBN5
3/4"	#UBN7
1"	#UBN10
1-1/4"	#UBN12
1-1/2"	#UBN15
2"	#UBN20
2-1/2"	#UBN25
3"	#UBN30
4"	#UBN40
6"	#UBN60
8"	#UBN80

**CONDUIT HANGER**



1/2"	#MINC5
3/4"	#MINC7
1"	#MINC10
1-1/4"	#MINC12
1-1/2"	#MINC15
2"	#MINC20
2-1/2"	#MINC25
3"	#MINC30
4"	#MINC40

**PIPE HANGERS**



**GALVANIZED BAND HANGER**

PIPE SIZE	ROD SIZE	
1/2"	3/8"	#GBH5
3/4"	3/8"	#GBH7
1"	3/8"	#GBH10
1-1/4"	3/8"	#GBH12
1-1/2"	3/8"	#GBH15
2"	3/8"	#GBH20
2-1/2"	3/8"	#GBH25
3"	3/8"	#GBH30
4"	3/8"	#GBH40
5"	1/2"	#GBH50
6"	1/2"	#GBH60
8"	1/2"	#GBH80



**FELT LINED BAND HANGER**

PIPE SIZE	ROD SIZE	
1/2"	3/8"	#FBH5
3/4"	3/8"	#FBH7
1"	3/8"	#FBH10
1-1/4"	3/8"	#FBH12
1-1/2"	3/8"	#FBH15
2"	3/8"	#FBH20
2-1/2"	3/8"	#FBH25
3"	3/8"	#FBH30
4"	3/8"	#FBH40

*Come on by!*



**PIPE HANGERS**



**CLEVIS HANGER**

3/4"	#CLH7
1"	#CLH10
1-1/4"	#CLH12
1-1/2"	#CLH15
2"	#CLH20
2-1/2"	#CLH25
3"	#CLH30
4"	#CLH40
5"	#CLH50
6"	#CLH60
8"	#CLH80
10"	#CLH100
12"	#CLH120



**QUESTIONS?**

**GIVE US A CALL**

**(714) 241-7050**

*We gladly accept...*



**ALL THREAD ROD**



**PLATED STEEL:** (10' LENGTHS)

- 1/4" #ATRP2
- 3/8" #ATRP3
- 1/2" #ATRP5
- 5/8" #ATRP58
- 3/4" #ATRP7

(3/8" ROD CHASER: #ABCH-030)

**STAINLESS STEEL:** (12' LENGTHS)

- 1/4" #SATR2
- 3/8" #SATR3
- 1/2" #SATR5

**ALL THREAD ROD CUTTER, 3/8"**



VERTICAL ROD CUTTER  
#RAB-3U

BLADES ONLY: #ABE3U

(FLOOR MOUNT, SEE PAGE 249)

**STEEL ANGEL CLIP**



FITS 3/8" & 1/2" ROD  
#SAC53

**ROD COUPLING**



- 1/4" #ROC2
- 3/8" #ROC3
- 1/2" #ROC5
- 5/8" #ROC58

- 3/8" x 1/4" #ROC32
- 1/2" x 3/8" #ROC53

**PIPE SUPPORT**



**BEAM CLAMP**

OPENS TO 3/4"

ROD SIZE

- 3/8" #BCL3
- 1/2" #BCL5



**CEILING FLANGE**

ROD SIZE

- 3/8" #CEF3
- 1/2" #CEF5



**SIDE BEAM CONNECTOR**

ROD SIZE

- 3/8" #SBC3
- 1/2" #SBC5



**DRIVE SCREW**

#16 x 2" #DS162



**LAG SCREW**

- 1/4" x 1-1/2" #LB215
- 1/4" x 2" #LB220
- 3/8" x 2" #LB320
- 3/8" x 3" #LB330

**PIPE SUPPORT**



**SUPER SCREW, BOTTOM MOUNT**

FOR WOOD: #SSW-38B  
FOR METAL: #SSM-38BR

(INSTALLATION TOOL: #UNI-B)



**SUPER SCREW, SIDE MOUNT**

FOR WOOD: #SSW-38S  
FOR METAL: #SSM-38SR

(INSTALLATION TOOL: #UNI-B)



**OFFSET EYE SOCKET**

ROD SIZE

3/8" #OSES



**COACH SCREW ROD**

4" LONG

ROD SIZE

- 3/8" #CSR3
- 1/2" #CSR5

**PIPE SUPPORT**

**GALVANIZED  
2 HOLE  
STRAP**



FITS SCHEDULE PIPE SIZE

1/2"	#401
3/4"	#402
1"	#403
1-1/4"	#404
1-1/2"	#405
2"	#406
2-1/2"	#407
3"	#408
4"	#410

**GALVANIZED  
1 HOLE  
STRAP**



FITS SCHEDULE PIPE SIZE

1/2"	#HW50
3/4"	#HW75
1"	#HW100
1-1/4"	#HW125
1-1/2"	#HW150
2"	#HW200

**NAIL ON  
SAFETY  
PLATE,  
16 GA.**



1-3/4" x 5" #2516

**PLATE  
STRAP,  
16 GA.**



1-1/2" x 9"	#PS-169
1-1/2" x 12"	#PS-1612
1-1/2" x 18"	#PS-1618

**PIPE SUPPORT**



**COPPER  
2 HOLE  
STRAP**

FITS COPPER TUBING

FITS	
1/8" (1/4" O.D.)	#CS21
1/4" (3/8" O.D.)	#CS22
3/8" (1/2" O.D.)	#CS23
1/2" (5/8" O.D.)	#CS25
3/4"	#CS27
1"	#CS210
1-1/4"	#CS212
1-1/2"	#CS215
2"	#CS220



**COPPER  
1 HOLE  
STRAP**

FITS COPPER TUBING

FITS	
1/8" (1/4" O.D.)	#CS11
1/4" (3/8" O.D.)	#CS12
3/8" (1/2" O.D.)	#CS13
1/2" (5/8" O.D.)	#CS15

**PLUMBERS TAPE**



**GALVANIZED:**  
3/4" x 10' 26 GA. #PT-26

**COPPER:**  
3/4" x 10' #CPS7

**PLASTIC:**  
3/4" x 25' #PPT725

**PIPE SUPPORT**



**PLASTIC  
2 HOLE  
STRAP**

FITS COPPER & PEX

1/2"	#P2PC5
3/4"	#P2PC7
1"	#P2PC10
1-1/4"	#P2PC12
1-1/2"	#P2PC15
2"	#P2PC20



**PLASTIC  
SUSPENSION  
CLAMP**

FITS COPPER & PEX

1/2"	#PSPC5
3/4"	#PSPC7
1"	#PSPC10
1-1/4"	#PSPC12
1-1/2"	#PSPC15
2"	#PSPC20



**PLASTIC  
PIPE  
INSULATOR**

FITS COPPER & PEX  
(1-3/8" HOLE SIZE)

1/2"	#PINP5
3/4"	#PINP7
1"	#PINP10

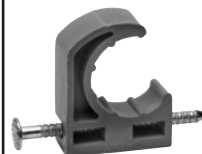

**PLASTIC  
PIPE  
CLAMP  
WITH NAIL**

FITS COPPER & PEX

1/2"	#PCWN5
3/4"	#PCWN7
1"	#PCWN10

**PIPE SUPPORT**



**COPPER PLATED STRAP**  
(1-3/4" WIDE)

TUBE SIZE	LENGTH	
1/2"	20"	#CPS5-20
1/2"	26"	#CPS5-26
3/4" & 1" 26"		#CPS10-26



**STOUT BRACKET, ADJ.**  
10" - 18" #SB1S  
13" - 25" #SB2S

**STOUT CLAMP:**  
FITS 1/2" - 1" COPPER #HR250



**HYCO STRAP**  
(5/8" WIDE)

LENGTH	
20"	#HYCO5820
26"	#HYCO5826

**COPPER HI-EAR HANGER**



1/2"	#CHC5
3/4"	#CHC7
1"	#CHC10

**PIPE SUPPORT**



**WIRE HANGER, 6" LONG**

**FOR COPPER:**

1/2"	#WPHC5
3/4"	#WPHC7



**J-HOOK, COATED**

**FOR COPPER:**

1/2" & 3/4"	#JHVC57
-------------	---------

**HEX HEAD TEK SCREW**



(100/BOX)

#8 x 1/2" SCREW: #TEKHW-812  
DRILL BIT TOOL: #MT8

**PIPE SUPPORT**



**CLIC® PIPE SUPPORT**

TUBE SIZE	PIPE SIZE	
1/2"	-	#CLI15
3/4"	1/2"	#CLI20
-	3/4"	#CLI25
1"	-	#CLI28
1-1/4"	1"	#CLI32
1-1/2"	1-1/4"	#CLI40
2"	-	#CLI51
-	2"	#CLI59
-	3"	#CLI80
-	4"	#CLI113



**FELT ROLL WITH ADHESIVE**

1/4" x 2" x 25' #170



**STRUT - CHANNEL**



**GREEN STRUT WITH HOLES**

DEEP	10'	#DSGWH
DEEP	20'	#DSGWH-20
SHALLOW	10'	#SSGWH

DEEP = 1-5/8" x 1-5/8"  
SHALLOW = 13/16" x 1-5/8"

**SOLID STRUT (NO HOLES)**



**PRE-GALVANIZED**

DEEP	10'	#DSNH
DEEP	20'	#DSNH-20
SHALLOW	10'	#SSNH
SHALLOW	20'	#SSNH-20

**BACK TO BACK STRUT (NO HOLES)**



**PRE-GALVANIZED 1-5/8" x 3-1/4"**

10'	#DSDNH
20'	#DSDNH-20

**STRUT - CHANNEL**



**DEEP STRUT WITH HOLES (STANDARD)**

PRE-GALVANIZED  
1-5/8" x 1-5/8"  
12 GA.

LENGTH

10'	#DSWH
20'	#DSWH-20

PRE-CUT LENGTHS:

6" LONG	#DSC60
12" LONG	#DSC12
18" LONG	#DSC18



**SHALLOW STRUT WITH HOLES**

PRE-GALVANIZED  
13/16" x 1-5/8"  
14 GA.

LENGTH

10'	#SSWH
20'	#SSWH-20

PRE-CUT LENGTHS:

6" LONG	#SSC60
12" LONG	#SSC12
18" LONG	#SSC18



**CAN'T FIND IT?**

**GIVE US A CALL.**

**(714) 241-7050**

**STRUT - CHANNEL**



**ALUMINUM STRUT (NO HOLES)**

DEEP	10'	#DSANH
SHALLOW	10'	#SSANH

DEEP = 1-5/8" x 1-5/8"  
SHALLOW = 13/16" x 1-5/8"



**STAINLESS STEEL STRUT (WITH HOLES)**

DEEP	10'	#DSSSWH
SHALLOW	10'	#SSSSWH



**FIBERGLASS STRUT (NO HOLES)**

DEEP	10'	#FGS1
SHALLOW	10'	#FGS2



**ROOF PYRAMID**

**#ROOFP**

FOR SUPPORTING AND SECURING ANY TYPE OF PIPING/TUBING ON ROOF TOPS.

9-3/4" LONG  
5" TALL  
6" WIDE BASE

**CUSHION STRUT CLAMP**



**PLASTIC CUSHION FORMS AN INSULATING LINER. ELIMINATES METAL TO METAL CONTACT.**

**FITS TUBE SIZE / O.D.:**

SIZE	FITS	
1/4"		#CSC2
3/8"		#CSC3
1/2"		#CSC5
5/8"	(1/2" COPPER)	#CSC58
3/4"		#CSC7
7/8"	(3/4" COPPER)	#CSC78
1"		#CSC10
1-1/8"	(1" COPPER)	#CSC118
1-1/4"		#CSC12
1-3/8"	(1-1/4" COPPER)	#CSC138
1-1/2"		#CSC15
1-5/8"	(1-1/2" COPPER)	#CSC158
2"		#CSC20
2-1/8"	(2" COPPER)	#CSC218
2-5/8"	(2-1/2" COPPER)	#CSC258
3-1/8"	(3" COPPER)	#CSC318
4-1/8"	(4" COPPER)	#CSC418

(IRON PIPE SIZE IN STOCK)

**VIBRATION STRIP**



**ELIMINATES METAL TO METAL CONTACT**

1-5/8" x 20' #V-STRIP

**FELT WITH ADHESIVE**



1/4" x 2" x 25' #170

**STRUT CLAMPS**



**PRE-GALVANIZED**

**FITS SCHEDULE PIPE:**

1/4"	#SCIP2
3/8"	#SCIP3
1/2"	#SCIP5
3/4"	#SCIP7
1"	#SCIP10
1-1/4"	#SCIP12
1-1/2"	#SCIP15
2"	#SCIP20
2-1/2"	#SCIP25
3"	#SCIP30
4"	#SCIP40
5"	#SCIP50
6"	#SCIP60
8"	#SCIP80
10"	#SCIP100
12"	#SCIP120

FOR CAST IRON NO-HUB PIPE, SEE NEXT COLUMN.

**FITS TUBE SIZE / O.D.:**

SIZE	FITS	
1/4"		#SCOD2
3/8"		#SCOD3
1/2"		#SCOD5
5/8"	(1/2" COPPER)	#SCOD58
3/4"		#SCOD7
7/8"	(3/4" COPPER)	#SCIP5
1"		#SCOD10
1-1/8"	(1" COPPER)	#SCIP7
1-1/4"		#SCOD12
1-3/8"	(1-1/4" COPPER)	#SCIP10
1-1/2"		#SCOD15
1-5/8"	(1-1/2" COPPER)	#SCIP12
2"		#SCOD20
2-1/8"	(2" COPPER)	#SCOD218
2-5/8"	(2-1/2" COPPER)	#SCOD258
3-1/8"	(3" COPPER)	#SCOD318
4-1/8"	(4" COPPER)	#SCOD418
6-1/8"	(6" COPPER)	#SCOD618

**STRUT CLAMPS**



**STAINLESS STEEL STRUT CLAMP**

**FITS SCHEDULE PIPE:**

1/2"	#SSCIP5
3/4"	#SSCIP7
1"	#SSCIP10
1-1/4"	#SSCIP12
1-1/2"	#SSCIP15
2"	#SSCIP20
2-1/2"	#SSCIP25
3"	#SSCIP30
4"	#SSCIP40
6"	#SSCIP60

**FITS TUBE SIZE / O.D.:**

1/4"	#SSCOD2
3/8"	#SSCOD3
1/2"	#SSCOD5
3/4"	#SSCOD7
1"	#SSCOD10



**FIBERGLASS STRUT CLAMP**

**FITS SCHEDULE PIPE:**

1/2"	#SCFG5
3/4"	#SCFG7
1"	#SCFG10
1-1/4"	#SCFG12
1-1/2"	#SCFG15
2"	#SCFG20
2-1/2"	#SCFG25
3"	#SCFG30
4"	#SCFG40



**FITS CAST IRON NO-HUB PIPE**

2"	#SCN20
3"	#SCN30
4"	#SCN40
5"	#SCN50
6"	#SCN60
8"	#SCN80

**STRUT FITTINGS**

**FLAT 90°**

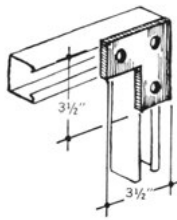

#W5021

**FLAT TEE**

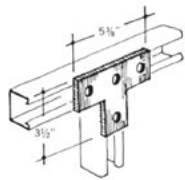

#W5022

**FLAT CROSS**

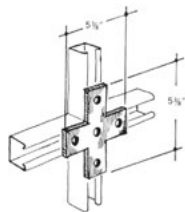

#W5023

**2 HOLE SPlice PLATE**

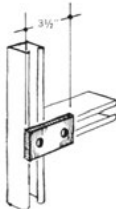

#W5007

**3 HOLE SPlice PLATE**

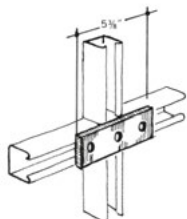

#W5008

**4 HOLE SPlice PLATE**

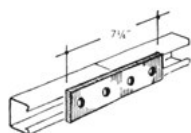

#W5009

**STRUT POST BASE**



4 HOLE BASE #SPBSQ

2 HOLE BASE #SPB2

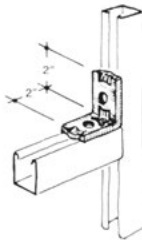

**2 HOLE 90° (INDENTED)**

#W5104

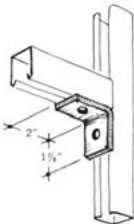

**2 HOLE 90°**

#W5103

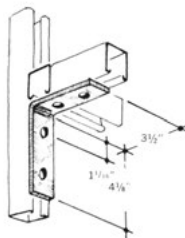

**4 HOLE 90°**

#W5123

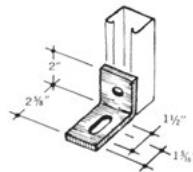

**2 HOLE 90° ADJUSTABLE SHORT SLOT**

#W5105

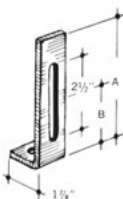

**2 HOLE 90° ADJUSTABLE LONG SLOT**

#W5107

**STRUT FITTINGS**

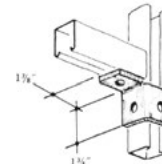

**3 HOLE LEFT CORNER ANGLE**

#W5511

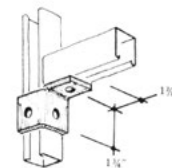

**3 HOLE RIGHT CORNER ANGLE**

#W5510

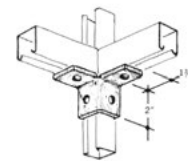

**4 HOLE 90° CORNER ANGLE**

#W5512

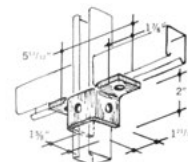

**5 HOLE TWO SIDE ANGLE CONNECTOR**

#W5513

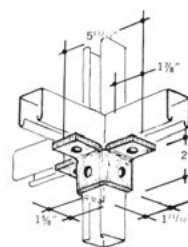

**6 HOLE THREE SIDE CORNER ANGLE CONNECTOR**

#W5514

**STRUT FITTINGS**

**CLOSED  
45°**

#W5465

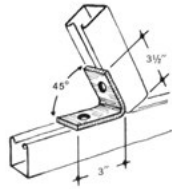

**OPEN  
45°**

#W5425

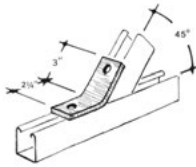

**“U”  
SUPPORT  
FOR  
DEEP  
STRUT**

#W5312

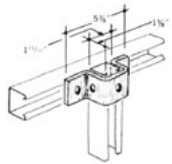

**“U”  
SUPPORT  
FOR  
SHALLOW  
STRUT**

#W5315

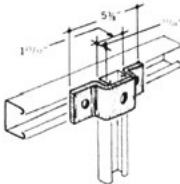

**U-BOLT  
BEAM CLAMP**

#W5709



**STRUT  
SAFETY  
PROTECTIVE  
END CAP**



**FITS:**  
DEEP STRUT      #SCAD  
SHALLOW STRUT      #SCAS

**STRUT NUTS**

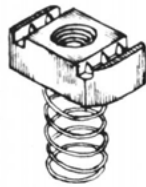

**CHANNEL  
NUT WITH  
SPRING**

**FOR DEEP STRUT:**

1/4"	#W-24
5/16"	#W-25
3/8"	#W-26
1/2"	#W-28

**FOR SHALLOW STRUT:**

1/4"	#W-54
3/8"	#W-56
1/2"	#W-58

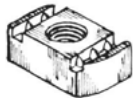

**CHANNEL  
NUT, NO  
SPRING**

**FOR DEEP STRUT:**

1/4"	#W-24WS
3/8"	#W-26WS
1/2"	#W-28WS



**HEX  
HEAD  
BOLT**

1/4" x 1"	#HB210
5/16" x 1"	#HB51610
3/8" x 1"	#HB310
1/2" x 1"	#HB510

OTHER SIZES, PAGE 149



**FLAT  
WASHER**

1/4"	#FW2
3/8"	#FW3
1/2"	#FW5

**CHANNEL BRACKET**

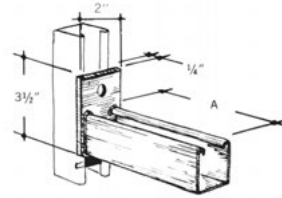

**LENGTH**

12"	#W5632
18"	#W5633
24"	#W5634

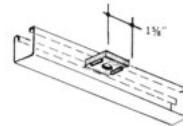

**SQUARE  
STRUT  
WASHER**

3/8"	#W5003
1/2"	#W5004

**RACHET & SOCKET  
TOOL**



**RATCHET:**  
3/8" DRIVE      #7014

**FITS  
SOCKET BOLT**

SIZE	SIZE	
7/16"	1/4"	#SOC716
9/16"	3/8"	#SOC916
3/4"	1/2"	#SOC7

OTHER SIZES, PAGE 254

**E-Z CHANNEL NUT**



**WITH  
PLASTIC  
GRIPPER**

FITS DEEP & SHALLOW STRUT  
3/8"      #EZCN-3



